

SuperPlank™ Decking Products

Metric Price List

All items are pultruded fiber reinforced polymer and available upon request in standard resin series: Isophthalic Polyester (I) – Isophthalic Polyester Fire Retardant (IFR) – Vinyl ester Fire Retardant (VFR)

Notes: 1) Stocked Items Available in 6.1m and 7.32m lengths.

2) IFR and VFR Resin Series are Class I Flame Rating 25 or less per ASTM E-84 and self extinguishing per ASTM D-635.

SuperPlank™ 2415 Decking

Note: Stocked Items are Highlighted and in Boldface Type.

Part Number	List Price/ Sq. Meter	List Price/ Linear Meter	Kgs./Sq. Meter with Anti-Skid	Kgs./Linear Meter with Anti-Skid	Color
GR205 - SHG (I)	\$201.42	\$122.78	13.2	8.0	Light Gray
GR205 - SHG (IFR)	215.71	131.53	13.2	8.0	Light Gray
GR205 - SHG (VFR)	252.57	153.96	13.2	8.0	Light Gray

Note: Minimum order quantity is 186 square meters or 372 linear meters for special resins, colors and lengths.

Panel Dimensions

609.6 mm Wide
38.1 mm High
99.6 mm CL Web
Spacing

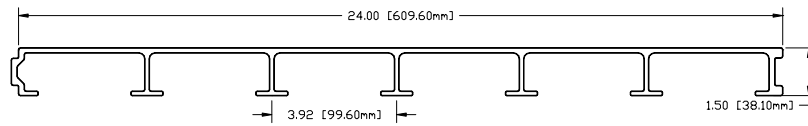

Pricing

Panel without slots, deduct \$2.69/sq. meter or \$1.64/linear meter after discount.

Panel without non-skid surface, deduct \$8.07/sq. meter or \$4.92/linear meter after discount.

Panels without slots and non-skid surface, deduct \$10.76/sq. meter or \$6.56/linear meter after discount.

SuperPlank™ 2415 Tread

Note: Stocked Items are Highlighted and in Boldface Type.

Part Number	List Price/Linear Meter	Kgs/Linear Meter	Color
GR205 -ST (IFR)	\$81.99	4.61	Molten Silver

Tread width is 254 mm inches. Available in various lengths.

Special widths are available upon request (up to 2.89 mm).

All prices on tread are NET; no discount applies.

Pricing for tread is the same with or without slots.

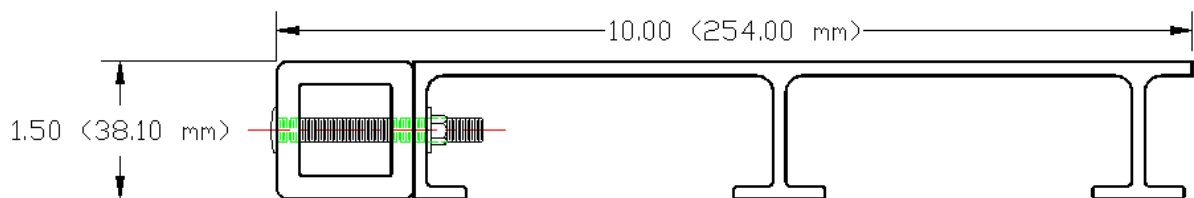

CREATIVE PULTRUSIONS, INC.

214 Industrial Lane ■ Alum Bank, Pennsylvania 15521 USA

Phone: +1 814-839-4186 ■ Fax: +1 814-839-4276

Web site: <http://www.creativepultrusions.com> ■ E-mail: crpul@pultrude.com

Decking Clips and Accessories

Item	Part Number	Price Each*
Top Surface Mount Assembly Kit Includes: Flat Head Bolt (8 mm x 18 x 70 mm) (CLP002) Nut (8 mm-18) (CLP003) Top Surface Washer (51mm dia.) 14 gauge thickness(CLP004) Flat Washer (8mm) (CLP031) Lock Washer (8mm) (CLP032)	CLK018	\$3.68
Heavy Duty Beam Clip Kit Includes: Heavy Duty Beam Clip Mount (CLP034) 7.9 mm – 18 x 38.1 mm Bolt 316SS (CLP035) 7.9 mm – 18 Nut 316SS (CLP036)	CLK020	9.71
Type A Flathead Self Tapping Screw	CLP033	0.05
Top Surface Washer	CLP004	2.43
<i>All prices are NET; no discount applies.</i>		
<i>*Due to volatility of the steel industry, please consult factory to verify pricing.</i>		



**Flat Head
Screw**

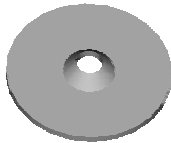

**Top Surface
Washer**



**Flat Head
Bolt**



Heavy Duty Beam Clip Mount

**Flat Head Screw is 18-8 Stainless.*

Top Surface Washer, Flat Head Bolt and Heavy Duty Mount Clip are 316 Stainless Steel.

General Information

Terms

Net 30 Days
FOB Factory

Delivery

Standard Panel:

- 1 – 25 panels – 5 to 10 working days
- 26 – 50 panels – 10 to 20 working days
- Over 50 panels – Consult Creative Pultrusions, Inc.

Fabricated Panel:*

- 1 – 25 panels – 10 to 15 working days
- 26 – 50 panels – 15 to 25 working days
- Over 50 panels – Consult Creative Pultrusions, Inc.

*Subject to change upon receipt of detailed fabrication drawings.

Drop Shipment Charge

Drop Shipment Charge: \$50.00

Minimum Order/Handling Charge

Less Than 10 Panels: \$50.00 Handling Charge
Less Than 5 Panels: \$100.00 Handling Charge

Cutting Charges

Minimum Cutting Charge: \$25.00
Straight Cuts: \$5.00/Linear Meter
Diagonal/Circular Cuts: \$8.20/Linear Meter
Price includes sealing of cut edges.
(Customer will be charged for full panel.)

Custom Color Charge

Color Charge: \$750.00 Per Color Match

Flowgrip® and Pultex® are registered trademarks of Creative Pultrusions, Inc. Creative Pultrusions™, Shaping the Future™, Superstud™, Superstud™/Nuts!, Superstik™, SUPURTUF™, Superplank™, Superdeck™, Supergrate™, Tuf-dek™, SuperLoc™, SuperWale™, SuperCap™, SuperRod™, Pultrusion Dynamics™, DYNAPUL™, Pulshaping™, TOPSCAN™ and TOPDIE™ are trademarks of Creative Pultrusions, Inc.

CPS009MET-1199.3K (DLR: 4/9/09)